



SWIFT

TREKKER



TREKKER

Introducing Trekker – the next generation campervan redefining adventure.

With a distinct grey matter body, black panelling and vibrant graphics the Trekker exudes ruggedness without compromising on style, making it stand out in any setting. Engineered for road-ready performance, Trekker is fit for exploration and new adventures afar.

Stepping inside, comfort meets style in a harmonious blend. The pop-top roof easily allows space for both couples and families. The space also includes efficient storage solutions, a well equipped kitchen and on-board washroom. Embark on your adventure today with the Trekker and experience the freedom to explore.

2 layouts to choose from



4 berths



3500kg MTPLM



Drivable on standard
Cat B licence



Trekker Layout Configuration

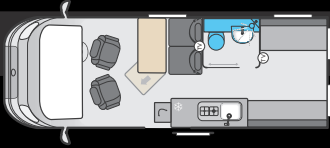

Trekker
Day

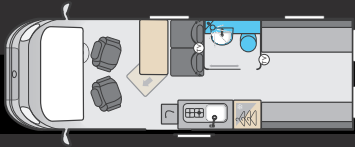

Trekker X
Day



Trekker
Night



Trekker X
Night

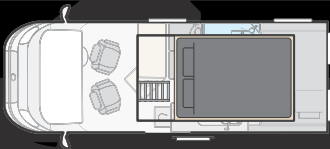
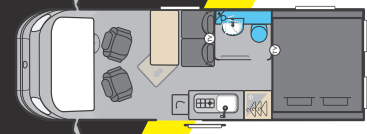

Trekker
Pop Top Bed

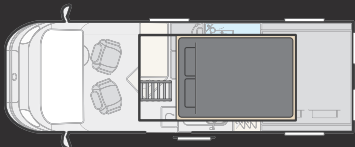

Trekker X
Pop Top Bed



Trekker Key Features

Exterior

- Ford Transit Panel Van in Grey Matter with black bumpers and eye-catching graphics
- Euro 6D 170bhp, 2.0 litre TDCi EcoBlue engine with 6-speed manual transmission
- Stylish 16" alloy wheels in Matt Black

Driving

- Driver and passenger captain chairs both with:
 - Fully upholstered covers
 - Swivel Base
 - Position, height and rake adjustment
 - Integrated headrest
- Zenec Xzent F-285 infotainment system with 9" touchscreen, integrated into dashboard, including DAB/FM RDS Radio with Apple Carplay™ / Android Auto™, USB, Bluetooth and rear parking aids

Living, Relaxing & Sleeping

- High-Level rear fold-down beds allowing storage down the centre
- Forward facing travelling seats with armrest to sidewall, incorporating USB socket
- Fully sealed waterproof washroom incorporating a duckboard, foldaway wash basin, coat hanging and foldaway garment rail
- Elevating roof system featuring:
 - Dual zipped windows complete with midge screens
 - Double bed with independent bed springs for additional comfort and fall-out protection

Eating

- Combination Dometic two-burner stainless steel hob and sink with glass lids
- Dometic 50 litre compressor fridge (70 litre on Trekker X)
- Combined oven & grill (Trekker X)
- Fold-out worktop extension
- External BBQ point

Utilities

- Control system with 4" LCD colour touchscreen panel featuring: Simple controls for monitoring and managing:
 - Power
 - Battery selection, battery level meter and power usage
 - Selected lighting control with soft-start dimming
- Fully sealed, long life, 100 Amp-hour (Dir 2006/66/EC) leisure battery
- Whale heating and water system
- Underslung 65 litre fresh water tank and 55 litre waste tank, both heated



Safety and Security

- Smoke alarm
- Carbon monoxide alarm

Options

- 170bhp, 2.0 litre TDCi Ford EcoBlue engine with 6 speed automatic transmission

Trekker Specification

	 Trekker		 Trekker X	
	Standard	Optional	Standard	Optional
Ford Ecoblue MultiJet diesel engine	170bhp Manual	170bhp Auto	170bhp Manual	170bhp Auto
Engine capacity	2.0ltr		2.0ltr	
Engine power	170bhp @ 3500rpm		170bhp @ 3500rpm	
Engine torque	390Nm @ 2750rpm		390Nm @ 2750rpm	
Chassis	Pop Top Panel Van		Pop Top Panel Van	
Wheel base	3.30m / 10' 10"		3.75m / 12' 4"	
Seat belts (inc. driver)	4		4	
Berths (sleeping positions)	4		4	
Overall length	5.53m / 18' 2"		5.98m / 19' 7"	
Overall body width (mirrors folded)	2.11m / 6' 11"		2.11m / 6' 11"	
Overall height (pop up roof down)	2.98m / 9' 9"		2.98m / 9' 9"	
Standard awning	Thule 5200 3.0m		Thule 5200 3.5m	
Maximum technical permissible laden mass (A)	3500kg		3500kg	
Mass in running order (B)	2970kg	3015kg	3085kg	3130kg
Maximum user payload (A-B)	530kg	485kg	415kg	370kg
Bed sizes				
Rear Bed	185cm x 123cm / 6'1" x 4'0"		185cm x 136cm / 6'1" x 4'6"	
Roof bed	205cm x 130cm / 6'8" x 4'3"		205cm x 130cm / 6'8" x 4'3"	

1. The Maximum User Payload includes:

- The conventional load (this is the allowance for passengers)
- Essential habitation equipment (items and fluids required for safe and proper functioning of habitation equipment)
- Optional equipment (items available from the manufacturer over and above the standard specification)

d. Personal effects (those items not covered by the above)

- The Mass in Running Order is the mass of the unladen vehicle including a 75kg allowance for the driver plus engine coolants and 90% of the fuel tank capacity and 11kg for LPG.

3. The MRO is calculated with the fresh water tank and water heater empty. If you travel with water in the fresh water tank or water heater then the payload will reduce accordingly.

- Please take care to ensure that you have allowed for the masses of all items you intend to carry in the vehicle, e.g. passengers, optional equipment, essential habitation equipment and

personal effects, such as clothing, food, pets, bicycles, sailboards, sports equipment etc.

- Warning - under no circumstances should the maximum technical permissible laden mass of the vehicle be exceeded.



Wherever the road takes you, stay connected.

We're excited to welcome you to a **community** built on the values of comfort and convenience. Just like any family, we want to ensure that you are always **connected** and secure, especially when it comes to your adventures in your **Swift Campervan**.

Ford Assistance Plan

A Ford Assistance Plan makes it easy to get back on the road. If you run into trouble, our roadside assistance team will be given your precise location, and information on your vehicle, so they know the issue before arrival*

Remote Start

Cold morning? Automatic vehicles can be started remotely so that they're warmed up, de-iced and ready to go when you are.

Health Status + Alerts

Your vehicle's health is important. Discovering potential issues early can make a huge difference. See your vehicle's health status in detail, and get alerts when something needs your attention.

Download the free FordPass App now to unlock key features and functionality.

Scan the QR code below to find out more...



** The Ford Roadside Assistance feature requires an active Ford Roadside Assistance Plan. Ford policy is one of continuous product development. The right is reserved to change the items illustrated and described. FordPass features shown are available with selected vehicle models and specifications.*



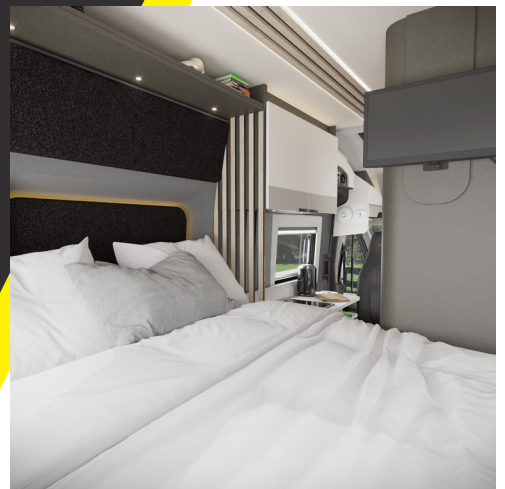
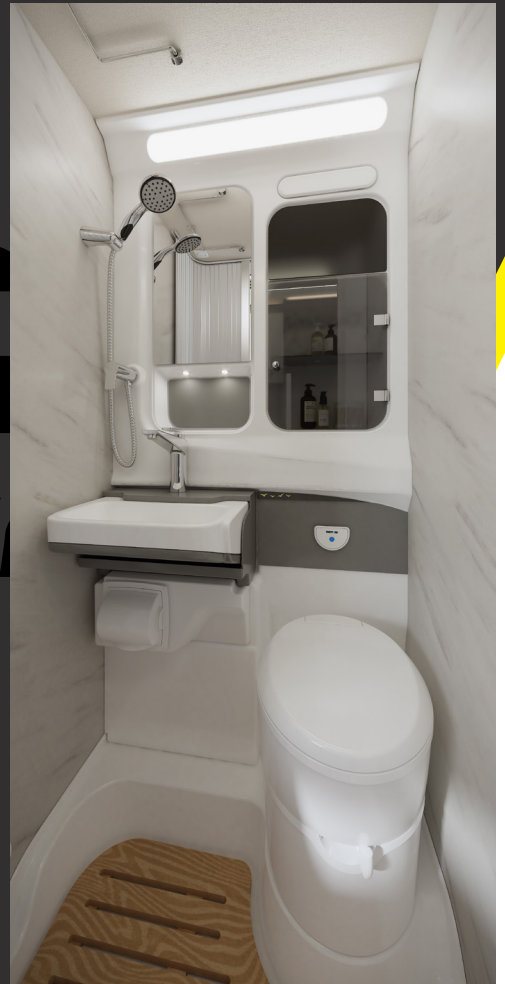

Join the Swift community



Visit our website at [swiftgroup.co.uk](https://www.swiftgroup.co.uk)



Your Home Anywhere

 **MANUFACTURED
IN BRITAIN**